

COPYRIGHT © Hangzhou EZVIZ Software Co., Ltd. ALL RIGHTS RESERVED.

Any and all information, including, among others, wordings, pictures, graphs are the properties of Hangzhou EZVIZ Software Co., Ltd. (hereinafter referred to as “EZVIZ”). This user manual (hereinafter referred to as “the Manual”) cannot be reproduced, changed, translated, or distributed, partially or wholly, by any means, without the prior written permission of EZVIZ. Unless otherwise stipulated, EZVIZ does not make any warranties, guarantees or representations, express or implied, regarding to the Manual.

About this Manual

The Manual includes instructions for using and managing the product. Pictures, charts, images and all other information hereinafter are for description and explanation only. The information contained in the Manual is subject to change, without notice, due to firmware updates or other reasons. Please find the latest version in the EZVIZ™ website (<http://www.ezviz.com>).

Revision Record

New release – January, 2025

Trademarks Acknowledgement

EZVIZ™, ™, and other EZVIZ's trademarks and logos are the properties of EZVIZ in various jurisdictions. Other trademarks and logos mentioned below are the properties of their respective owners.

Legal Disclaimer

TO THE MAXIMUM EXTENT PERMITTED BY APPLICABLE LAW, THE PRODUCT DESCRIBED, WITH ITS HARDWARE, SOFTWARE AND FIRMWARE, IS PROVIDED “AS IS”, WITH ALL FAULTS AND ERRORS, AND EZVIZ MAKES NO WARRANTIES, EXPRESS OR IMPLIED, INCLUDING WITHOUT LIMITATION, MERCHANTABILITY, SATISFACTORY QUALITY, FITNESS FOR A PARTICULAR PURPOSE, AND NON-INFRINGEMENT OF THIRD PARTY. IN NO EVENT WILL EZVIZ, ITS DIRECTORS, OFFICERS, EMPLOYEES, OR AGENTS BE LIABLE TO YOU FOR ANY SPECIAL, CONSEQUENTIAL, INCIDENTAL, OR INDIRECT DAMAGES, INCLUDING, AMONG OTHERS, DAMAGES FOR LOSS OF BUSINESS PROFITS, BUSINESS INTERRUPTION, OR LOSS OF DATA OR DOCUMENTATION, IN CONNECTION WITH THE USE OF THIS PRODUCT, EVEN IF EZVIZ HAS BEEN ADVISED OF THE POSSIBILITY OF SUCH DAMAGES.

TO THE MAXIMUM EXTENT PERMITTED BY APPLICABLE LAW, IN NO EVENT SHALL EZVIZ'S TOTAL LIABILITY FOR ALL DAMAGES EXCEED THE ORIGINAL PURCHASE PRICE OF THE PRODUCT.

EZVIZ DOES NOT UNDERTAKE ANY LIABILITY FOR PERSONAL INJURY OR PROPERTY DAMAGE AS THE RESULT OF PRODUCT INTERRUPTION OR SERVICE TERMINATION CAUSED BY: A) IMPROPER INSTALLATION OR USAGE OTHER THAN AS REQUESTED; B) THE PROTECTION OF NATIONAL OR PUBLIC INTERESTS; C) FORCE MAJEURE; D) YOURSELF OR THE THIRD PARTY, INCLUDING WITHOUT LIMITATION, USING ANY THIRD PARTY'S PRODUCTS, SOFTWARE, APPLICATIONS, AND AMONG OTHERS.

REGARDING TO THE PRODUCT WITH INTERNET ACCESS, THE USE OF PRODUCT SHALL BE WHOLLY AT YOUR OWN RISKS. EZVIZ SHALL NOT TAKE ANY RESPONSIBILITIES FOR ABNORMAL OPERATION, PRIVACY LEAKAGE OR OTHER DAMAGES RESULTING FROM CYBER ATTACK, HACKER ATTACK, VIRUS INSPECTION, OR OTHER INTERNET SECURITY RISKS; HOWEVER, EZVIZ WILL PROVIDE TIMELY TECHNICAL SUPPORT IF REQUIRED. SURVEILLANCE LAWS AND DATA PROTECTION LAWS VARY BY JURISDICTION. PLEASE CHECK ALL RELEVANT LAWS IN YOUR JURISDICTION BEFORE USING THIS PRODUCT IN ORDER TO ENSURE THAT YOUR USE CONFORMS TO THE APPLICABLE LAW. EZVIZ SHALL NOT BE LIABLE IN THE EVENT THAT THIS PRODUCT IS USED WITH ILLEGITIMATE PURPOSES.

IN THE EVENT OF ANY CONFLICTS BETWEEN THE ABOVE AND THE APPLICABLE LAW, THE LATTER PREVAILS.

Table of Contents

Overview	1
1. Package Contents	1
2. Basics	1
Installation Procedure.....	2
1. Preparation	2
2. Top Mounting	2
3. Wall Mounting	5
4. Wiring on the Gate Opener	6
Technical Data.....	6
Information for Private Households	7

Overview

1. Package Contents

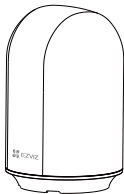

Alarm Light (x1)

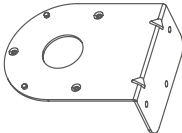

Wall Bracket (x1)

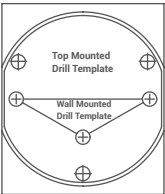

Drill Template (x1)



Screw Kit (x2)



Regulatory Information (x1)



Quick Start Guide (x1)

-  This product must be used with an EZVIZ gate opener (hereinafter referred to as "gate opener").
- There may be different types of gate openers and gates. The gate opener and gate illustrations in this user manual are for reference only.

2. Basics

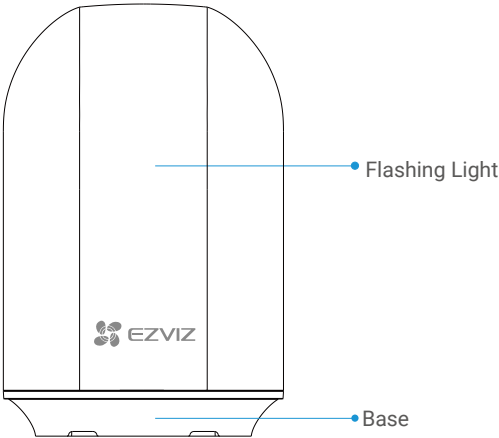

Front View

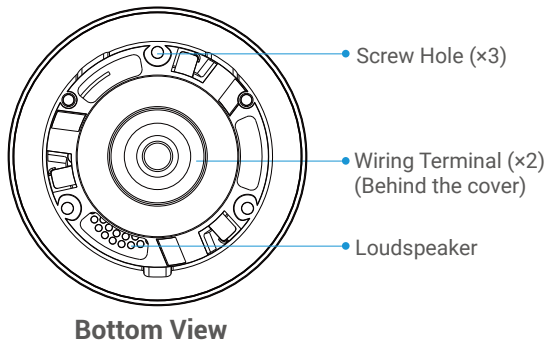

Installation Procedure

- Before installing the alarm light, make sure to disconnect the gate opener from power.
- It is recommended to install the alarm light on the same side as the gate opener, which is the side to which the gate opens.
- Wire specifications: $2 \times 0.75\text{mm}^2$, maximum length: 10m.
- Be careful not to short-circuit the wires when connecting.

1. Preparation

1. If any existing alarm light is installed on the pillar, remove it first. The wires can be retained for use.
2. The alarm light requires two wires for connection to the gate opener. If there are no wires, please drill holes and get wires ready first.
3. Choose between top mounting and wall mounting based on the structure of your gate and pillars.

2. Top Mounting

1. Choose an appropriate installation location on top of the pillar and stick the drill template (ensuring that the installation area is clean and flat).
2. Use a drill bit (5.5mm diameter) to drill holes according to the three points along the circle on the drill template (drilling depth: about 25mm).

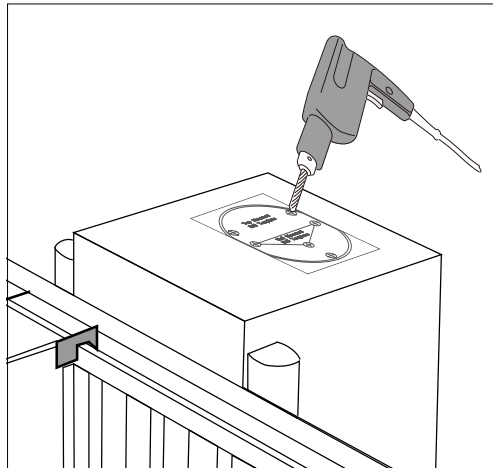

3. Remove the drill template, put anchors in the holes, and hammer them just into the holes.

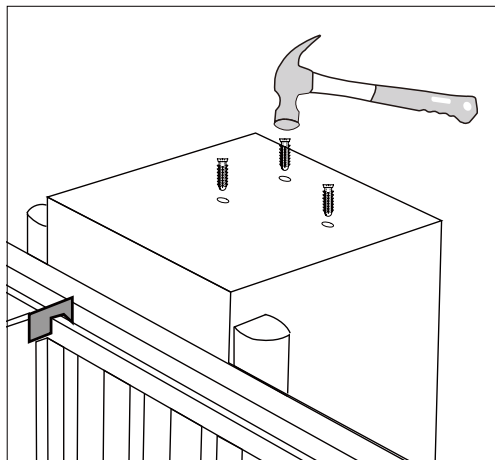

4. Rotate the base of the alarm light counterclockwise to separate the base from the flashing light.

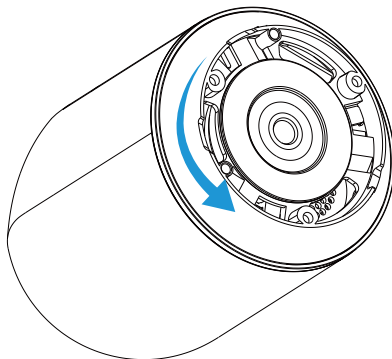

5. Poke a hole in the center of the silicone cover of the base for the wire to go through.
6. Peel off the insulating sheath of two concealed wires for 6-10mm and pass the wires through the hole in the silicone cover.
7. Align the three screw holes on the base with the drilled holes on top of the pillar. Use three screws to fix the base.

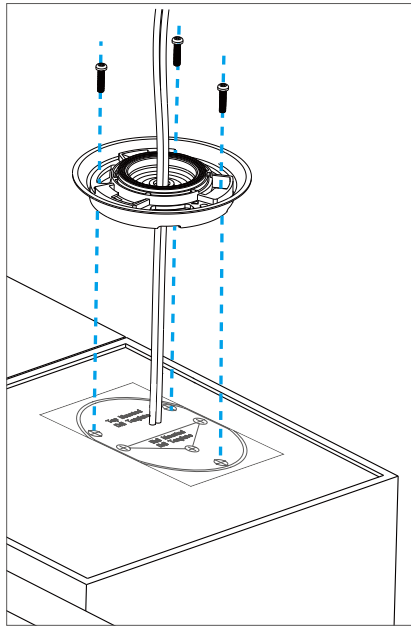

8. Connect wires to the alarm light.

- a. Use a screwdriver to loosen the two screws on the two wiring terminals.
- b. Connect the wires to the two wiring terminals (polarity-insensitive).
- c. Use a screwdriver to tighten the screws back on the wiring terminals.

9. Align the arrow sign on the bottom of the flash light with the arrow on the base and rotate the flashing light clockwise. The flashing light will be fixed on the base.

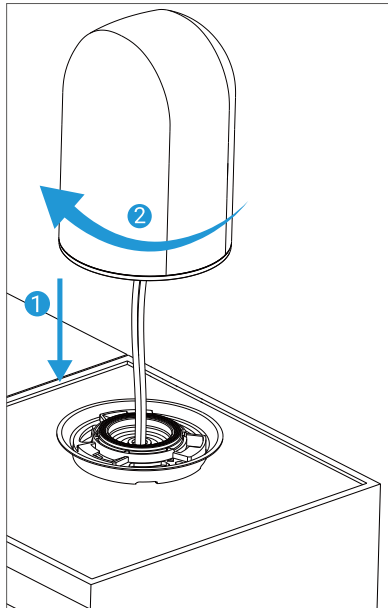

3. Wall Mounting

If your gate and pillars are not suitable for top mounting, you can use wall mounting.

- For wall mounting, it is recommended that the alarm light should be installed at a height of 1.5 to 2.5 meters.
- Operation details of wall mounting are similar to those of top mounting and therefore are not repeated here.

1. Separate the base from the flashing light and fix the base onto the wall bracket (included in the package).
2. Choose an appropriate installation location on the wall of the pillar and install the wall bracket.
3. Connect wires and fix the flashing light on the wall bracket.

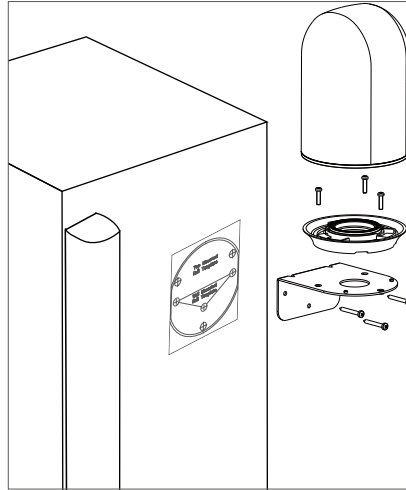

4. Wiring on the Gate Opener

- 1. Loosen the two screws on the “FLASH” terminals on the gate opener.
- 2. Insert the two wires of the alarm light into the “FLASH” terminals separately.
- 3. Tighten the screws back on the two terminals.
- i* Make sure that the screws are tightened properly and the wires will not fall off.
- 4. Use a cable tie to fix the wires in the cable holder.

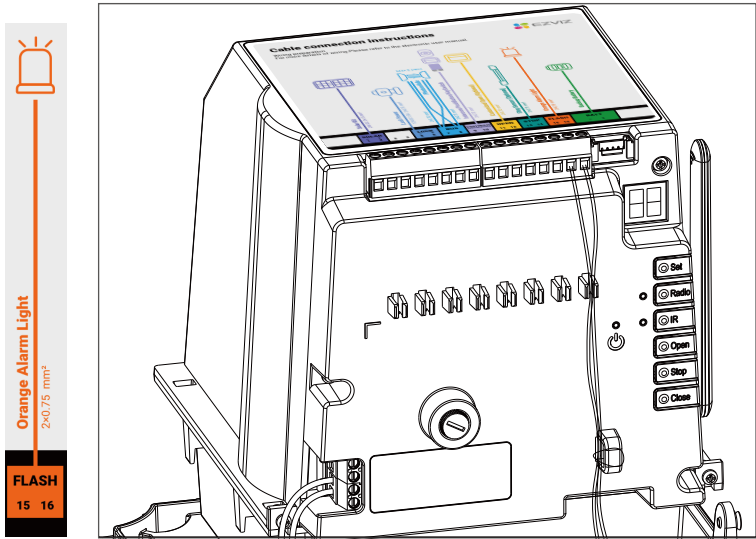

Technical Data

Item	Description
Connection Method	Wired connection (2-wired), Digital signal transmission
Operation conditions	-30°C to 55°C, humidity 95% or less (non-condensing)
Protection rating	IP55

Information for Private Households

1. Separate collection of waste equipment: Electrical and electronic equipment that has become waste is referred to as waste equipment. Owners of waste equipment must dispose of it separately from unsorted municipal waste. In particular, waste equipment does not belong in household waste, but in special collection and return systems.
2. Batteries and rechargeable batteries as well as lamps: Owners of waste equipment shall, as a rule, separate waste batteries and rechargeable batteries that are not enclosed in the waste equipment, which can be removed from the waste equipment without being destroyed, from the waste equipment before handing them in at a collection point. This does not apply if waste equipment is prepared for reuse with the participation of a public waste management authority.
3. Options for returning waste equipment: Owners of waste equipment from private households can return it free of charge to the collection points of the public waste management authorities or to the take-back points set up by manufacturers or distributors within the meaning of the Electrical and Electronics Equipment Law. Stores with a sales area of at least 400 m² for electrical and electronic equipment and those grocery stores with a total sales area of at least 800 m² that offer electrical and electronic equipment several times a year or on a permanent basis and make it available in the market are required to take it back. This also applies in the case of distribution using means of distance communication, if the storage and shipping areas for electrical and electronic equipment are at least 400 m² or the total storage and shipping areas are at least 800 m². Distributors shall, in principle, ensure take-back by providing suitable return facilities at a reasonable distance from the respective end user. The possibility of returning waste equipment free of charge exists for distributors who are obliged to take it back, among other things, if a new similar device that essentially fulfills the same functions is delivered to an end user.
4. Privacy Notice: Waste equipment often contains sensitive personal data. This applies in particular to devices of information and telecommunications technology such as computers and smartphones. In your own interest, please note that each end user is responsible for deleting the data on the waste equipment to be disposed of.
5. Meaning of the symbol “crossed-out wheelie bin”: The symbol of a crossed-out wheelie bin regularly depicted on electrical and electronic equipment indicates that the respective device is to be collected separately from unsorted municipal waste at the end of its service life.